

### SERIES "MBV/TMBV" 2-WAY & 3-WAY\* TRUE UNION MANUAL BALL VALVES 3" & 4" SIZES

#### FEATURES:

- Full port.
- Bi-directional flow.
- Low maintenance and extended operational life.
- Handle equipped as a spanner device to adjust carrier.
- PTFE seat energized by O-ring.
- Ball machined and tumbled to ensure roundness.
- Special mounting pads are molded on body for actuator mounting or valve anchoring.
- Blow-out proof stem.
- Safety shear stem design.
- Double O-ring seal on stem.

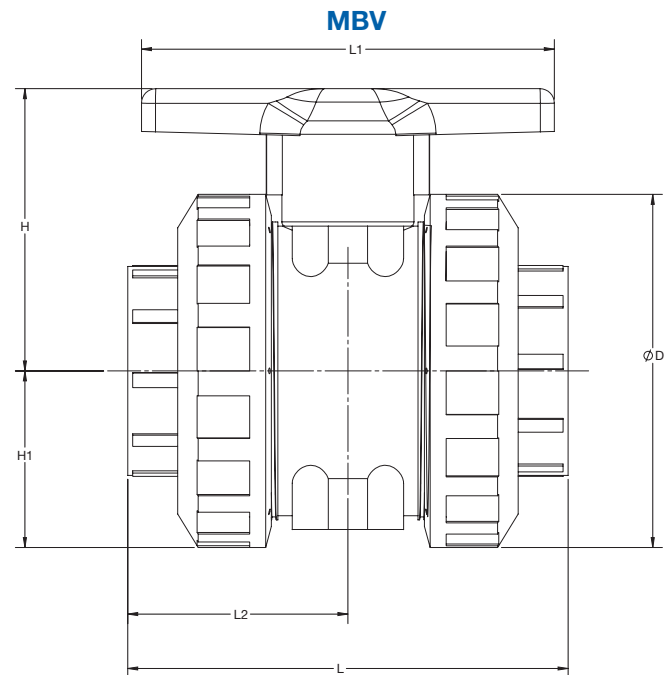
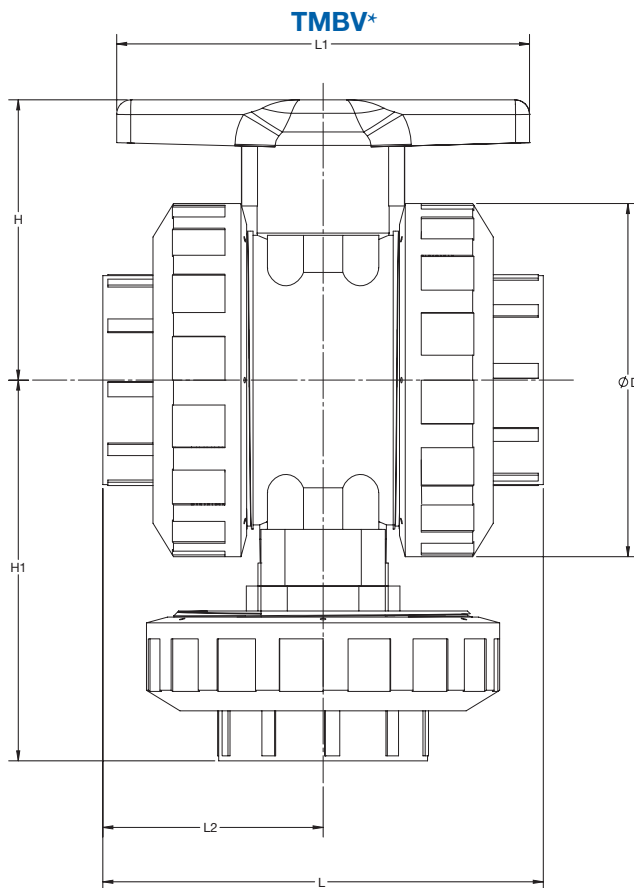

MODEL	L		L1		L2		D		H		H1	
	IN	MM	IN	MM	IN	MM	IN	MM	IN	MM	IN	MM
MBV300	10.8	274.3	9.1	230	5.3	134	7.1	181.1	6.5	165	3.7	94.2
MBV400	12.6	320.0	10.8	274.3	5.7	145.6	9.2	233.6	7.4	186.7	4.6	116.8
TMBV300*	10.8	274.3	9.1	230	5.3	134	7.1	181.1	6.5	165	8.3	210.3
TMBV400*	12.6	320.0	10.8	274.3	5.7	145.6	9.2	233.6	7.4	186.7	9.9	251.8

\*TMBV 3" and 4" are Specialty Custom; please contact factory for minimum quantities, pricing, and lead time.

### MATERIAL GUIDELINE FOR PRESSURE & TEMPERATURE

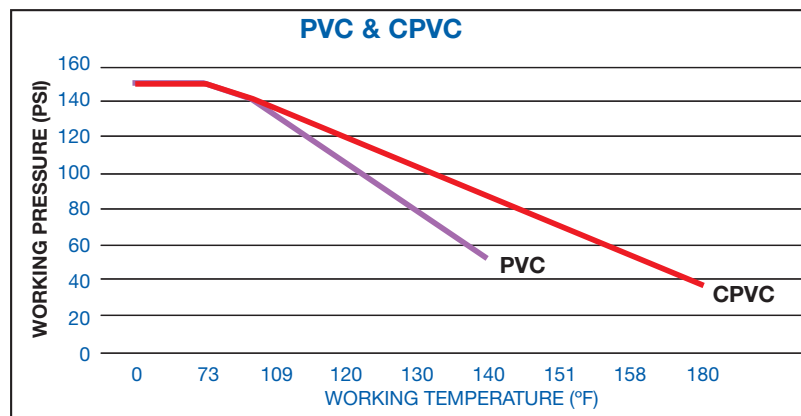
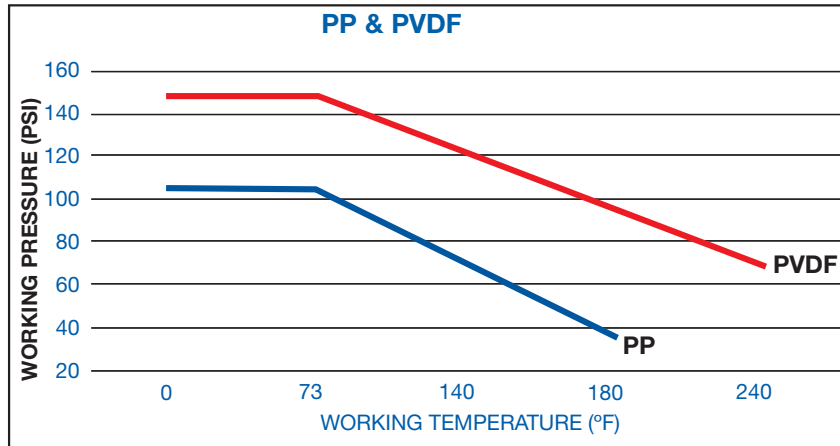

#### MATERIALS OF CONSTRUCTION:

**PVC:** Class 1245B per ASTM D1784

**CPVC:** Class 1245B per ASTM D1784

**PP:** Class PP 110B76383 per ASTM D4101

**PVDF:** Type 1 per ASTM D3222

**Seals:** EPDM or FKM

**Seats:** PTFE

#### ORDERING INFORMATION

2-Way Valve Size	Cv Factor	PVC Model #	CPVC Model #	Polypro Model #	PVDF Model #
3", 2-way	490	MBV300VT-PV	MBV300VT-CP	MBV300VT-PP	MBV300VT-PF
4", 2-way	770	MBV400VT-PV	MBV400VT-CP	MBV400VT-PP	MBV400VT-PF
3 Way Valve Size	Cv Factor	PVC Model #	CPVC Model #	Polypro Model #	PVDF Model #
3", 3-way	132	CONSULT FACTORY	CONSULT FACTORY	N/A	N/A
4", 3-way	200	CONSULT FACTORY	CONSULT FACTORY	N/A	N/A

#### NOTES:

1. Model numbers shown are with FKM (Viton) seals. For EPDM seals, change the second "V" to "EP".
2. Model numbers shown are with threaded connections. For socket connections, change the "T" to "S".
3. Model numbers listed with "-A" denote 3-hole ball.